

# MHS RAUCH-350-SC

air-cooled

screwable

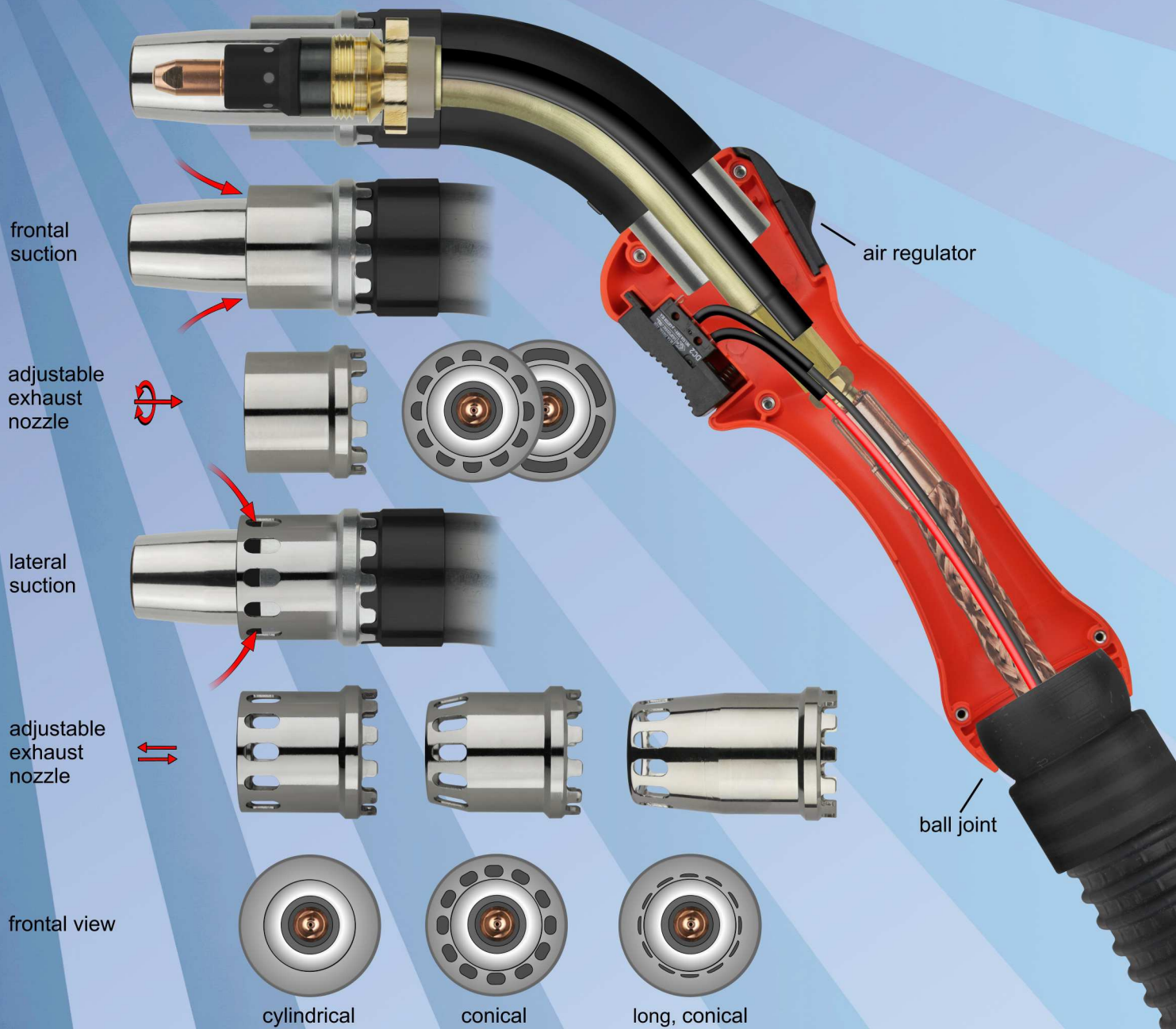

## Version B

contact tip M8 x 30 + gas diffuser "black power" + contact tip holder



350 Amp./100% duty cycle (CO<sub>2</sub>)  
310 Amp./100% duty cycle (mixed gas)

## Spare parts:

MHS RAUCH-450-SC water-cooled

# MHS RAUCH-350-SC **screwable**

air-cooled

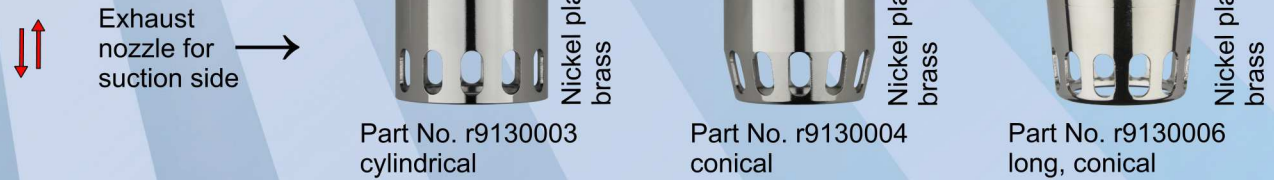
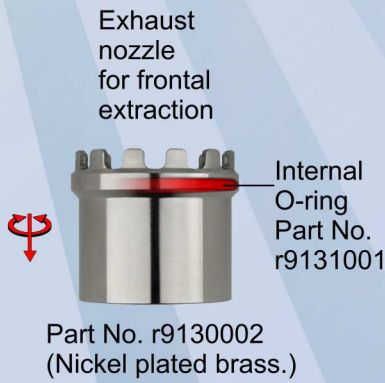
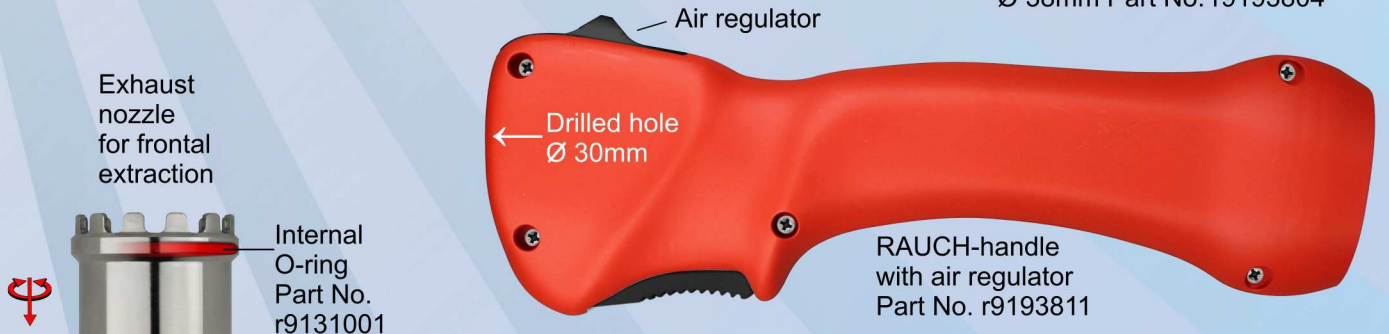
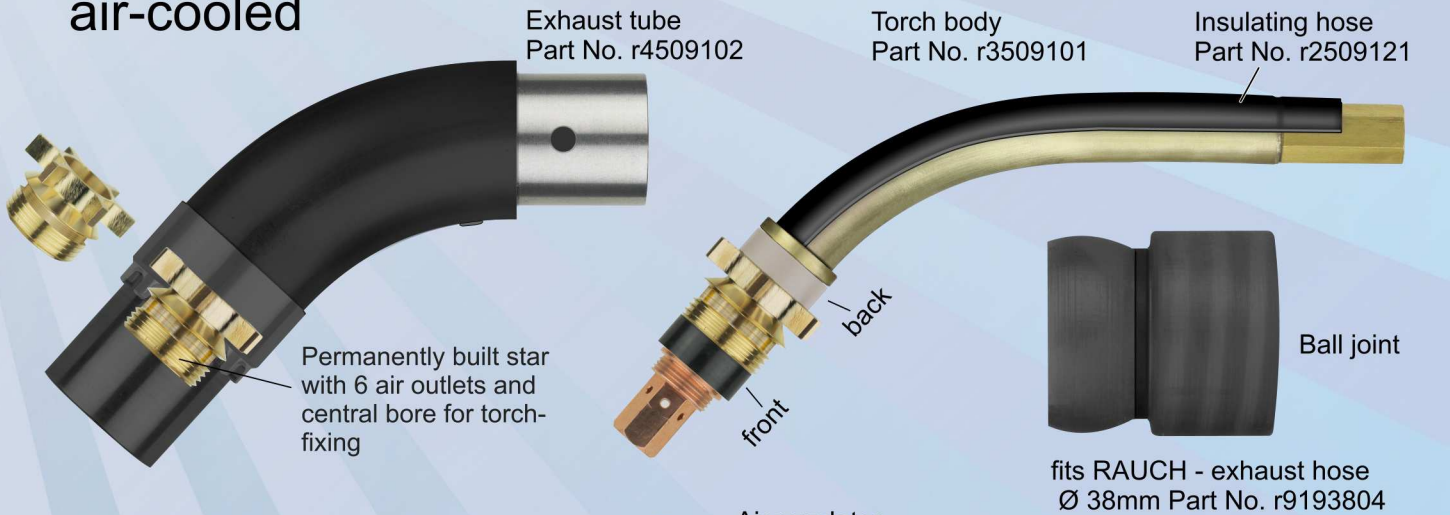

□ Please fill in wire diameter



HSN 868B-6



# MHS RAUCH-350-SC screwable air-cooled

350 Ampere at 100% duty cycle (CO<sub>2</sub>) - 310 Ampere at 100% duty cycle (mixed gas)

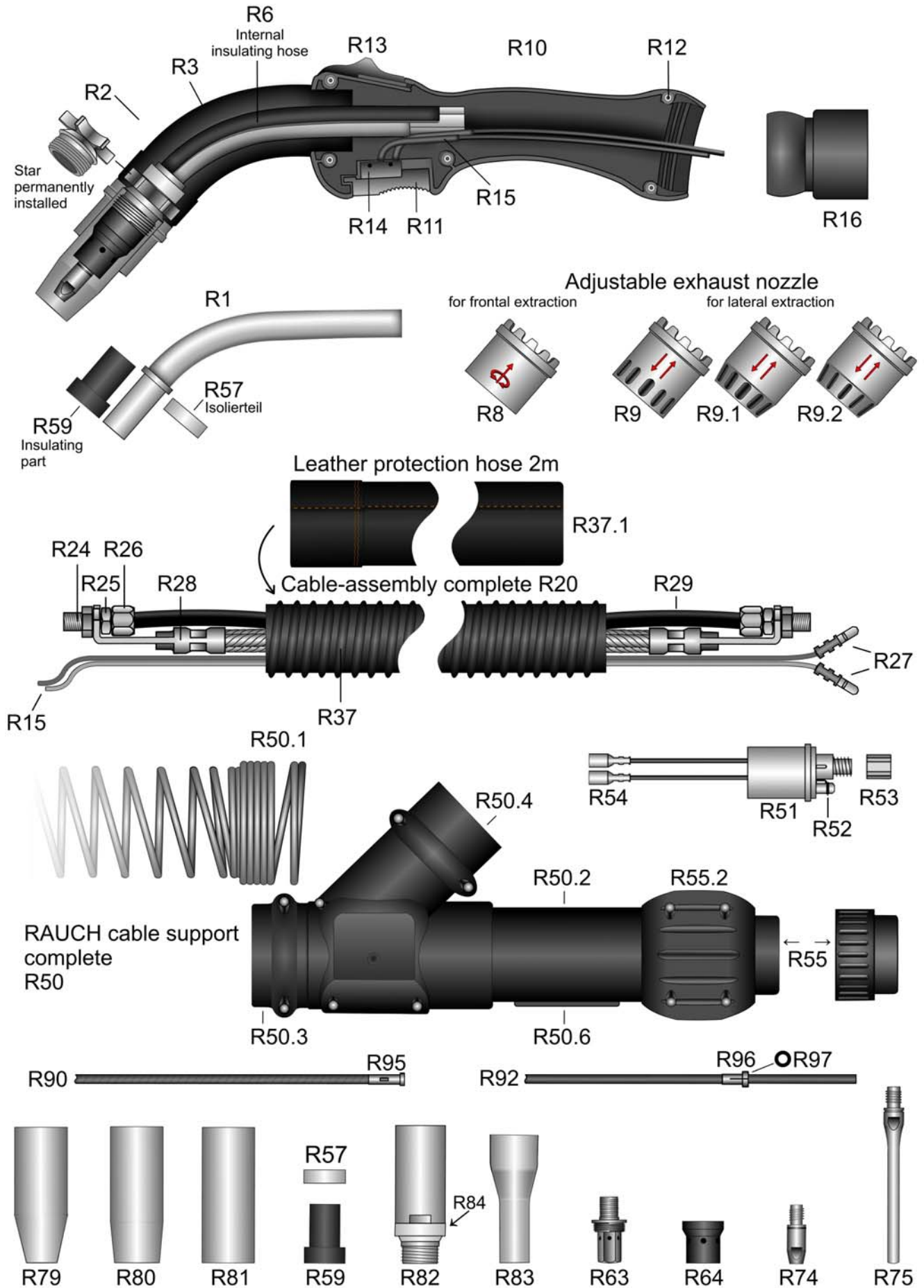

HSN 869-7

## MHS RAUCH-350-SC screwable

### Welding-torch MIG-MAG air-cooled

350A at 100% duty cycle (CO<sub>2</sub>) - 310A at 100% duty cycle (mixed gas)

#### Art.-No.

#### Spare parts as torch MHS RAUCH-400 water-cooled

r3500311	Torch MHS RAUCH-350-SC screwable / 3m EURO central adapter exhaust hose ID38mm
r3500411	Torch MHS RAUCH-350-SC screwable / 4m EURO central adapter exhaust hose ID38mm
r3500511	Torch MHS RAUCH-350-SC screwable / 5m EURO central adapter exhaust hose ID38mm

**For torches without EURO central-adaptor the following prices apply.  
Please note that for some special machine side connections surcharges may arise,  
which you will find in the appendix "A" custom made products.**

r3500301	Torch MHS RAUCH-350-SC screwable / 3m exhaust hose ID38mm
r3500401	Torch MHS RAUCH-350-SC screwable / 4m exhaust hose ID38mm
r3500501	Torch MHS RAUCH-350-SC screwable / 5m exhaust hose ID38mm

R1	r3509101	Swan neck MHS RAUCH-350-SC fits version screwable + pluggable
R2	r4509102	Fume suction tube for torch body RAUCH-350-SC/450-SC screwable
R3	r3509103	Fume suction tube fits screwable gas nozzle with Swan neck complete with all consumables (conatct tip 1,0), without fume suction nozzle
R6	r2509121	Section of silicone/glas insulating hose ID12,6-L125mm heat resistant up to 200°C
R8	r9130001	Fume suction nozzle for RAUCH-350-SC / RAUCH-450-SC made of aluminium, frontal suction, adjustable, complete with special o-ring high temperature resistant
R8	r9130002	Fume suction nozzle for RAUCH-350-SC / RAUCH-450-SC made of brass, nickel plated, frontal suction, adjustable, complete with special o-ring high temperature resistant
R9	r9130003	Fume suction nozzle for RAUCH-350-SC / RAUCH-450-SC made of brass, nickel plated, lateral suction, adjustable, complete with special o-ring high temperature resistant
R9.1	r9130004	Fume suction nozzle for RAUCH-350-SC / RAUCH-450-SC made of brass, nickel plated, conical, lateral suction, wide suction slots, complete with special o-ring high temperature resistant
R9.3	r9130006	Fume suction nozzle narrow-gap (long) for RAUCH-350-SC / RAUCH-450-SC made of brass, nickel plated, conical, narrow suction slots, complete with special o-ring high temperature resistant
N.i.	r9131001	Special high heat resistant O-ring ID33-W2mm for fume suction nozzle RAUCH-350-SC / RAUCH-450-SC

**RAUCH-handle complete with air-slider, switch and all sundries.  
Please order ball joint separately.**

R10	r9193811	RAUCH-handle red
R11	91912440	Ratio push button black
R12	91920703	M3 mounting socket fits Ratio/Industry/RAUCH handle and cable support
N.i.	91920702	Screw M3x11,5mm fits Ratio/Industry/RAUCH handle and cable support
R13	r9193812	RAUCH-air slider black
R14	91912438	Ratio microswitch DC2 also fits RAUCH handle

#### Reel goods:

**Prices are per meter and only applicable if a complete reel is purchased.**

R15	91902601	Meter control line 2x0,5mm <sup>2</sup> silicone red (100m)
R15	91902602	Meter control line 2x0,5mm <sup>2</sup> silicone white (100m)
N.i.	s5080001	Meter shrinking hose, heatresistant 2:1, ID50,8mm (5m)

R16	r9193804	RAUCH-ball joint fits hose ID38mm
-----	----------	-----------------------------------

**Cable assembly for EURO central adapter  
separate cables with power conduit 44mm<sup>2</sup>**

R20	ve290311	Spare cable assembly RAUCH-350-SC 3m / without EURO central adapter exhaust hose ID38mm, complete with 2m leather protection sleeve
-----	----------	---

## MHS RAUCH-350-SC screwable

### Welding-torch MIG-MAG air-cooled

350A at 100% duty cycle (CO<sub>2</sub>) - 310A at 100% duty cycle (mixed gas)

<b>Art.-No.</b>		
R20	ve290411	Spare cable assembly RAUCH-350-SC 4m / without EURO central adapter exhaust hose ID38mm, complete with 2m leather protection sleeve
R20	ve290511	Spare cable assembly RAUCH-350-SC 5m / without EURO central adapter exhaust hose ID38mm, complete with 2m leather protection sleeve
R23	15912201	Lock-nut M10x1-L6mm for Swan neck
R24	neu61002	Power/wire connector for separate lines
R25	neu61004	Hex nut for power connector separate lines
R27	91902901	Male connector cable-plug for machine side EURO central adapter
R28	r9444311	RAUCH power supply 44mm <sup>2</sup> / 3m with 90° angled copper connecting plate / wall thickness 2mm
R28	r9444411	RAUCH power supply 44mm <sup>2</sup> / 4m with 90° angled copper connecting plate / wall thickness 2mm
R28	r9444511	RAUCH power supply 44mm <sup>2</sup> / 5m with 90° angled copper connecting plate / wall thickness 2mm
N.i.	neu61021	Spacer fits RAUCH power connection air-cooled for separate lines 37mm <sup>2</sup> + 44mm <sup>2</sup> 3,7mm
R29	r9500311	RAUCH wire conduit MHS / 3m EURO, hard ID6,0-W1,0 / color: black / PA
R29	r9500411	RAUCH wire conduit MHS / 4m EURO, hard ID6,0-W1,0 / color: black / PA
R29	r9500511	RAUCH wire conduit MHS / 5m EURO, hard ID6,0-W1,0 / color: black / PA
<b>Reel goods:</b> <b>Prices are per meter and only applicable if a complete reel is purchased.</b>		
N.i.	r3800001	Meter exhaust hose ID38mm (18m)
N.i.	r3800011	Leather-sleeve ID-45mm appr. 2m long, for fume extraction hose ID-38mm
R37	r3800311	Section of exhaust hose 2,4m ID38mm / for 3m RAUCH torch
R37	r3800411	Section of exhaust hose 3,4m ID38mm / for 4m RAUCH torch
R37	r3800511	Section of exhaust hose 4,4m ID38mm / for 5m RAUCH torch
R37.1	r3800011	Leather-sleeve ID-45mm appr. 2m long, for fume extraction hose ID-38mm
R50	91700002	Fume central adapter connection-system for air-cooled torches complete. Consisting of: 91700061 + 91700011 + 91700021 + 91700031 + 91700151 + 91700041 + 91900702
R50.1	91912611	Cable support spring machine side fits RAUCH Holch cable support
R50.2	91700061	Fume central adapter / fume protected area to connect support lines, lateral mouth for rubber grommet, 2 halves complete with bushing and screws and 1 red O-ring
R50.3	91700011	Fume central adapter chamber rotatable 360°. 2 halves complete with bushing, screws and 2 O-rings (red). Fits to genuine Holch extraction connection adapter 4° and central adapter connection chamber
R50.4	91700021	Fume central adapter extraction connection 45°, 2 half pieces complete with bushes and screws. Only for genuine Holch central adapter rotatable extraction chamber
N.i.	91700032	Fume central adapter membrane OD35-8mm thick for the genuine Holch fume protected central adapter connection chamber for air-cooled RAUCH fume extraction torch
50.6	91700151	Fume central adapter seal set for air cooled torches to seal the opening in the fume protected connection chamber
N.i.	r9131002	Special high heat resistant O-ring ID33mm-W2mm for fume extraction connection chamber
N.i.	91700111	Special high heat resistant O-ring ID46mm-W2mm fits fume extraction chamber
R51	91900106	Central adapter spring contact-pins EURO central adapter
R51	91900101	Central adapter fixed contact-pins EURO central adapter
R52	91900801	O-ring ID4-W1mm fits gas-nipple EURO central adapter
R53	91900901	Coupling nut IT-M10x1 (rounded edges) fits EURO central adapter
R54	91903001	Female connector cable-plug fits machine side EURO central adapter

## MHS RAUCH-350-SC screwable

### Welding-torch MIG-MAG air-cooled

350A at 100% duty cycle (CO<sub>2</sub>) - 310A at 100% duty cycle (mixed gas)

Art.-No.		
R55	91900702	Terminal nut insulated fits EURO central adapter (widened fits RAUCH)
R55.2	91700041	Strengthening for terminal nut EURO central adapter 2 halves complete with bushing and screws (black)
R57	r9120002	Peek insulation for RAUCH-350-SC / RAUCH-450-SC (back)
R59	r9121001	HT-insulation black power fits RAUCH-350-SC / RAUCH-450-SC (front) with long cylinder
R63	r9800002	Contact tip holder M8 with OT-M16x1 fits gas diffusor
R64	r9120004	HT-gasdiffusor black power with IT-M16x1 and drilling 18mm black
R74	83008401	Contact tip M8-L30-D10 CuCrZr 0,8
R74	83010401	Contact tip M8-L30-D10 CuCrZr 1,0
R74	83012401	Contact tip M8-L30-D10 CuCrZr 1,2
R74	83014401	Contact tip M8-L30-D10 CuCrZr 1,4
R74	83008a01	Contact tip M8-L30-D10 0,8-A for aluminium wire
R74	83010a01	Contact tip M8-L30-D10 1,0-A for aluminium wire
R74	83012a01	Contact tip M8-L30-D10 1,2-A for aluminium wire
R75	88551241	Narrow gap-contact tip M8-L85,5-D10 turned down to 6mm 1,2 CuCrZr
R79	r9310001	Screwable gas nozzle conical-ID12mm (long cone)
R80	r9300001	Screwable gas nozzle conical ID16mm
R81	r9330001	Screwable gas nozzle cylindric ID21mm
R82	r4509362	Narrow-gap lower section with PTFE sealing ring for RAUCH-350-SC / RAUCH-450-SC
R83	r4509365	Narrow gap gas-nozzle ID12-OD12mm / length 62,5mm for narrow-gap lower section RAUCH-350-SC / RAUCH-450-SC
R84	r4509363	PTFE sealing ring for narrow-gap lower section RAUCH-350-SC / RAUCH-450-SC
R90	15451311	Guide spiral-liner blue ID1,5-AD4,5 fits 3m / EURO central adapter
R90	15451411	Guide spiral-liner blue ID1,5-AD4,5 fits 4m / EURO central adapter
R90	15451511	Guide spiral-liner blue ID1,5-AD4,5 fits 5m / EURO central adapter
R90	20451311	Guide spiral-liner red ID2,0-AD4,5 fits 3m / EURO central adapter
R90	20451411	Guide spiral-liner red ID2,0-AD4,5 fits 4m / EURO central adapter
R90	20451511	Guide spiral-liner red ID2,0-AD4,5 fits 5m / EURO central adapter
R90	23481311	Spiral-liner green ID2,3-AD4,8 fits 3m / EURO central adapter
R90	23481411	Spiral-liner green ID2,3-AD4,8 fits 4m / EURO central adapter
R90	23481511	Spiral-liner green ID2,3-AD4,8 fits 5m / EURO central adapter
R90	25451311	Flatwire spiral-liner yellow ID2,5-AD4,5 fits 3m / EURO central adapter
R90	25451411	Flatwire spiral-liner yellow ID2,5-AD4,5 fits 4m / EURO central adapter
R90	25451511	Flatwire spiral-liner yellow ID2,5-AD4,5 fits 5m / EURO central adapter
R92	20393311	PTFE-carbon core liner ID2,0-AD3,9 fits 3m / EURO central adapter
R92	20393411	PTFE-carbon core liner ID2,0-AD3,9 fits 4m / EURO central adapter
R92	20393511	PTFE-carbon core liner ID2,0-AD3,9 fits 5m / EURO central adapter
R92	27473311	PTFE-carbon core liner ID2,7-AD4,7 fits 3m / EURO central adapter
R92	27473411	PTFE-carbon core liner ID2,7-AD4,7 fits 4m / EURO central adapter
R92	27473511	PTFE-carbon core liner ID2,7-AD4,7 fits 5m / EURO central adapter

## MHS RAUCH-350-SC screwable

Welding-torch MIG-MAG air-cooled

350A at 100% duty cycle (CO<sub>2</sub>) - 310A at 100% duty cycle (mixed gas)

<b>Art.-No.</b>		
R92	20406311	PA-carbon core liner black ID2,0-AD4,0 fits 3m / EURO central adapter
R92	20406411	PA-carbon core liner black ID2,0-AD4,0 fits 4m / EURO central adapter
R92	20406511	PA-carbon core liner black ID2,0-AD4,0 fits 5m / EURO central adapter
R92	23476311	PA-core liner black ID2,3-AD4,7 fits 3m / EURO central adapter
R92	23476411	PA-core liner black ID2,3-AD4,7 fits 4m / EURO central adapter
R92	23476511	PA-core liner black ID2,3-AD4,7 fits 5m / EURO central adapter
N.i.	20405002	Brass spiral liner blue L300mm IG fits AD3,9/4,0mm
N.i.	20405001	Brass spiral liner green L300mm IG fits AD4,7mm
R95	91905721	Nipple (brass L-30mm) fits spiral liner EURO central adapter AD 4,5mm
R96	91906111	Nipple fits core liner EURO central adapter AD3,9/4,0mm
R96	91906121	Nipple fits core liner EURO central adapter AD 4,7mm
R97	91906131	O-ring ID3,5-W1,5mm fits core liners
N.i.	91906112	Support tube, brass ID4,4 - AD5,0 - L200mm